

## MP2-G Series Overview

### Description

Cosmau MP2-G series multiple passage rotary unions with 2 channel for media transfer, design for compressed air, gas in rotating system.

- Transmit compressed air, gas when 360°unrestricted rotation
- Combined with electrical slip ring,transfer power,control signal, data
- Through hole or flange structure optional
- Available all kinds of custom solutions



### Specifications

Item	
Pneumatic Channel	2
Pressure	-100kPa ~ 10bar
Connection Szie	M5, 1/8" 1/4", 3/8", 1/2"
Connection Type	NPT, BSPP
Operating Temperature	-5° C to 80° C
Suitable Media	Air / Gas / Vacuum
Speed	200 RPM (reference value)
Material	AL alloy

All values listed under Technical Specifications are dependent on a combination of all application parameters. Please note operational life is dependent upon both rotational speed and duty cycle.

### Options

- Mounting Flange
- Connection Size
- Connection Type
- Material
- Pressure
- Media
- Optional Speed
- Combine with electrical slip ring

## INTRODUCE

## MP2-G

3

## MP2-G Series Dimensions

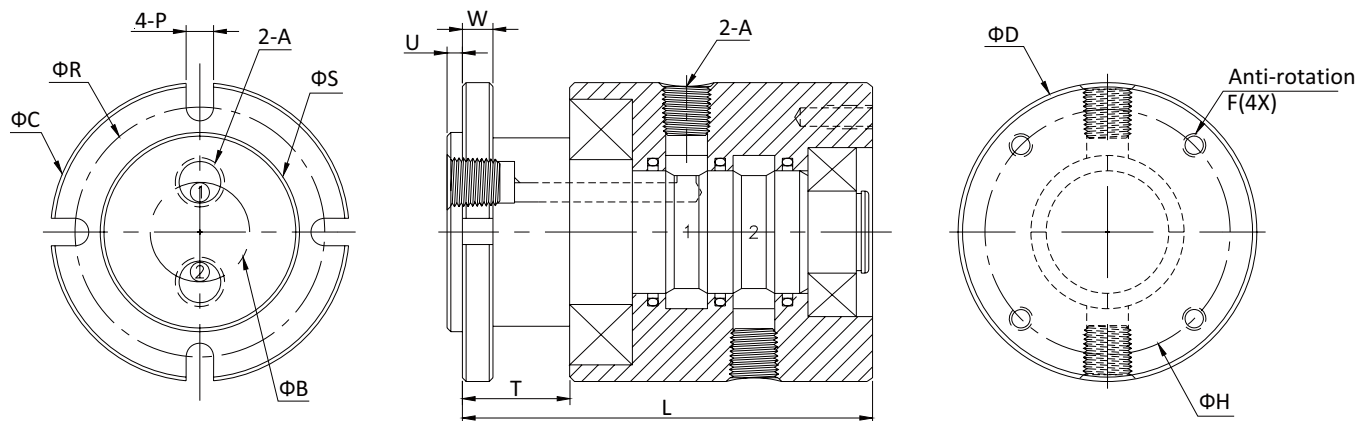

Part#	A(BSPP/NPT)	ΦB	ΦC	ΦD	ΦR	ΦS	U	W	T	P	F	ΦH	L
MP-201-G	1/8"	17	54.5	54.5	44.5	34	3	6	21	5.2	M5	44.5	69.6
MP-202-G	1/4"	20	59.5	59.5	50	40	3	6	21	5.2	M5	50	72.6
MP-203-G	3/8"	23	69.5	69.5	59	47	3	6	21	6.5	M6	59	80.5
MP-204-G	1/2"	27	79.5	79.5	69	58	3	7	25	6.5	M6	69	91.5