

## CMR4 Series Overview

### Description

Cosmau CMR4 series multiple passage rotary unions with 4 channel for media transfer, design for compressed air, gas in rotating system.

- Transmit compressed air, gas when 360°unrestricted rotation
- Combined with electrical slip ring,transfer power,control signal, data
- Through hole or flange structure optional
- Very low torque



### Specifications

Item	
Pneumatic Channel	4
Pressure	-100kPa ~ 1MPa
Connection Szie	M5, 1/8" 1/4", 3/8"
Connection Type	NPT, BSPP
Operating Temperature	-5° C to 80° C
Suitable Media	Air / Gas / Vacuum
Speed	200 RPM (reference value)
Material	AL alloy

All values listed under Technical Specifications are dependent on a combination of all application parameters. Please note operational life is dependent upon both rotational speed and duty cycle.

### Options

- Mounting Flange
- Connection Size
- Connection Type
- Material
- Pressure
- Media
- Optional Speed
- Combine with electrical slip ring

## INTRODUCE

## CMR4

5

## CMR4 Series Dimensions

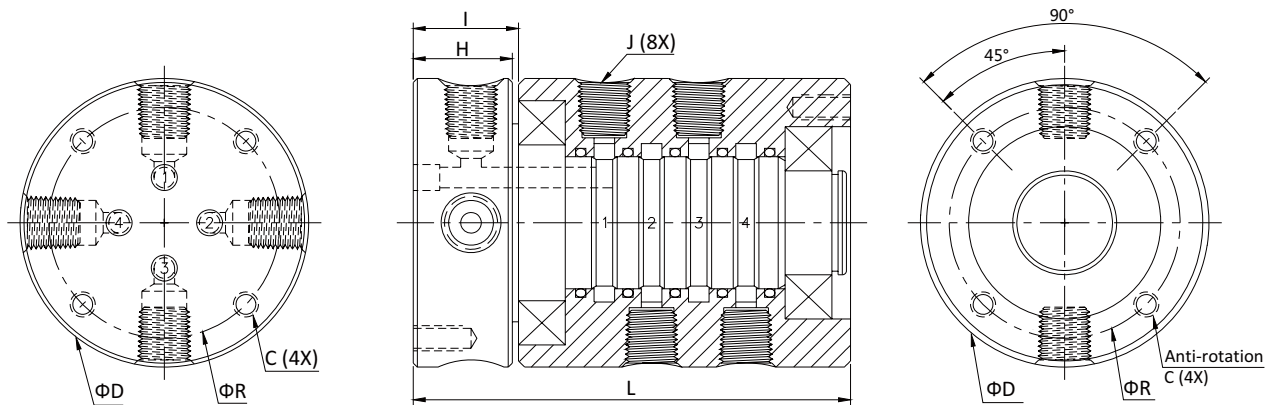

Part#	J(BSPP/NPT)	ΦR	C	ΦD	H	I	L
CMR-400	M5	37	M4	44	14	15	70
CMR-401	1/8"	45	M5	54	18.5	19.5	86
CMR-402	1/4"	45	M5	54	21.5	22.5	93
CMR-403	3/8"	58	M6	68	27.5	28.5	115